

Typ 21 NW 5 mm

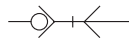

Werkstoffe:

Gewindestück..... Messing vernickelt
 Ventilkörper Messing vernickelt
 Entriegelungshülse.... Messing vernickelt
 Ventil..... Messing
 Federn, Sprengring.... Edelstahl 1.4310
 Kugeln..... Edelstahl 1.4034
 Dichtungen NBR
 Stecker Messing vernickelt

Temperaturbereich:

-20° bis +100°C

Betriebsdruck:

0 – 35 bar

Kv-Faktor:

0,6 m³/h

Andere Ausführung wie:

Werkstoffe, Dichtungen,
 Oberflächenbehandlung, beidseitig
 absperrend, ohne Ventil
auf Anfrage

Matières:

Partie filetée laiton nickelé
 Partie de soupape..... laiton nickelé
 Douille de
 verrouillage laiton nickelé
 Soupape..... laiton
 Ressorts, clips acier inox 1.4310
 Billes acier inox 1.4034
 Joints NBR
 Enfilables laiton nickelé

Température de service:

-20° à +100°C

Pression de service:

0 – 35 bar

Facteur kv:

0,6 m³/h

Autres exécutions comme:

Matières, Joints, Traitement de urface,
 avec soupape de retenue des 2 côtés, sans
 soupape de retenue
sur demande



Durchfluss Luft / Débit d'air

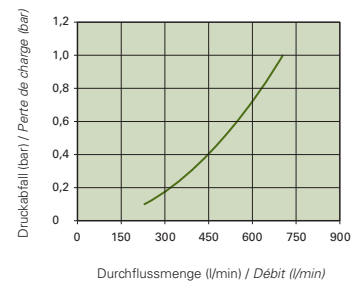

Verschlusskupplungen – Accouplements

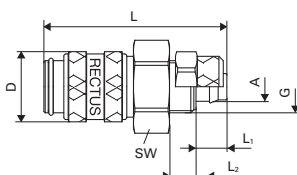
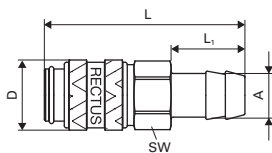
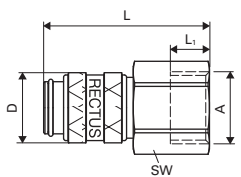
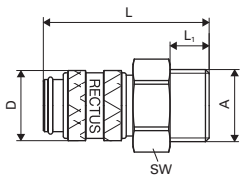

Art.-Nr. / No art.	A	SW	L	D	L ₁
21 KA AW 10 MPN	G1/8"	14	36	16	7
21 KA AW 13 MPN	G1/4"	17	38	16	9
21 KA AW 17 MPN	G3/8"	19	38	16	9

Art.-Nr. / No art.	A	SW	L	D	L ₁
21 KA IW 10 MPN	G1/8"	14	36	16	9
21 KA IW 13 MPN	G1/4"	17	38	16	9
21 KA IW 17 MPN	G3/8"	19	38	16	9

Art.-Nr. / No art.	A	SW	L	D	L ₁
21 KA TF 04 MPN	4	14	46	16	17
21 KA TF 06 MPN	6	14	46	16	17
21 KA TF 08 MPN	8	14	46	16	17
21 KA TF 09 MPN	9	14	46	16	17
21 KA TF 10 MPN	10	14	46	16	17

Art.-Nr. / No art.	A	SW	L	D	L ₁	L ₂	G
21 KA KO 06 MPN	6/4	14	42	16	7	6	M10x1
21 KA KO 08 MPN	8/6	14	42	16	7	6	M12x1

Verschlusskupplungen – Accouplements

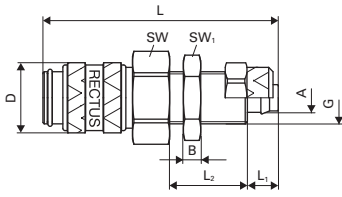

Art.-Nr. / No art.	A	SW	L	D	L ₁	L ₂	SW ₁	B	G
21 KA KS 06 MPN	6/4	14	54	16	7	18	14	4	M10x1
21 KA KS 08 MPN	8/6	17	54	16	7	18	17	4	M12x1

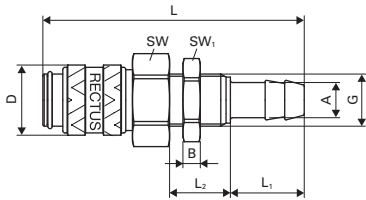

Art.-Nr. / No art.	A	SW	L	D	L ₁	L ₂	SW ₁	B	G
21 KA TS 04 MPN	4	12	60	16	17	14	12	4	M10x1
21 KA TS 05 MPN	5	17	60	16	17	14	17	4	M12x1
21 KA TS 06 MPN	6	17	60	16	17	14	17	4	M12x1
21 KA TS 08 MPN	8	17	60	16	17	14	17	4	M12x1

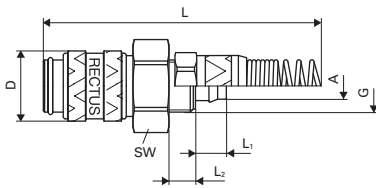

Art.-Nr. / No art.	A	SW	L	D	L ₁	L ₂	G
21 KA KK 06 MPN	6/4	14	125	16	7	6	M10x1
21 KA KK 08 MPN	8/6	14	130	16	7	6	M10x1

Stecknippel – Enfichables

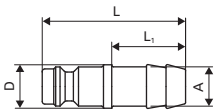

Art.-Nr. / No art.	A	L	D	L ₁
21 SF TF 04 MXN	4	32	9	17
21 SF TF 05 MXN	5	32	9	17
21 SF TF 06 MXN	6	32	9	17
21 SF TF 08 MXN	8	32	9	17
21 SF TF 09 MXN	9	33	10	17
21 SF TF 10 MXN	10	33	12	17

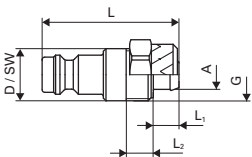

Art.-Nr. / No art.	A	SW	L	D	L ₁	L ₂	G
21 SF KO 06 MXN	6/4	–	32	10	6	6	M10x1
21 SF KO 08 MXN	8/6	–	32	12	6	6	M12x1
21 SF KO 10 MXN	10/8	17	36	–	9	8	M16x1

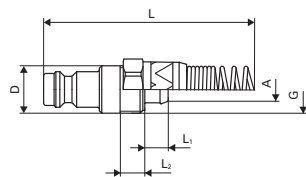

Art.-Nr. / No art.	A	L	L ₁	L ₂	G
21 SF KK 06 MXN	6/4	115	6	6	M10x1
21 SF KK 08 MXN	8/6	120	6	6	M12x1

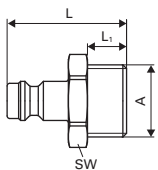

Art.-Nr. / No art.	A	SW	L	L ₁
21 SF AW 10 MXN	G ¹ / ₈ "	14	25	7
21 SF AW 13 MXN	G ¹ / ₄ "	17	28	9
21 SF AW 17 MXN	G ³ / ₈ "	17	28	9

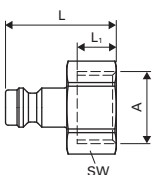

Art.-Nr. / No art.	A	SW	L	L ₁
21 SF IW 10 MXN	G ¹ / ₈ "	14	25	8
21 SF IW 13 MXN	G ¹ / ₄ "	17	25	9
21 SF IW 17 MXN	G ³ / ₈ "	19	26	9